

WIRE ROPE CLIPS



WIRE ROPE CLIPS

SIZE ROPE	MINIMUM CLIPS REQUIRED	AMT. WIRE ROPE TO TURN BACK	TORQUE IN POUNDS FOOT	APPROX. WEIGHT IN POUNDS	MALLEABLE WIRE ROPE CLIPS						
					A	B	C	D	E	F	G
1/16"	3	4"	--	.03	.15	.65	.45	.38	.38	.45	.69
1/8"	3	4.3/4"	--	.04	.18	.81	.50	.50	.50	.56	.94
3/16"	3	5.1/2"	2.6	.063	.25	.94	.56	.56	.56	.63	1.06
1/4"	3	7"	12	.13	.31	1.19	.75	.75	.69	.75	1.31
5/16"	3	7.3/4"	12	.15	.31	1.31	.84	.75	.75	.75	1.44
3/8"	3	9.1/2"	18.5	.21	.38	1.63	1.00	.88	.84	.88	1.63
7/16"	4	10.1/4"	18.5	.37	.44	2.00	1.19	1.06	1.00	1.06	1.88
1/2"	4	15.1/4"	25	.37	.44	2.00	1.19	1.06	1.00	1.06	1.88
9/16"	4	16"	35	.59	.50	2.31	1.38	1.25	1.25	1.28	2.09
5/8"	4	16"	35	.59	.50	2.31	1.38	1.25	1.25	1.28	2.09
3/4"	5	22.1/4"	50	.84	.56	2.56	1.56	1.31	1.44	1.56	2.38
7/8"	5	23.1/2"	100	1.25	.63	3.06	1.81	1.63	1.75	1.81	2.88
1"	6	31"	100	1.66	.63	3.44	2.00	1.88	2.06	2.00	3.00
1.1/8"	7	39"	140	2.43	.75	4.00	2.75	2.00	2.19	2.06	3.38

MALLEABLE WIRE ROPE CLIPS

Electro-Galvanized

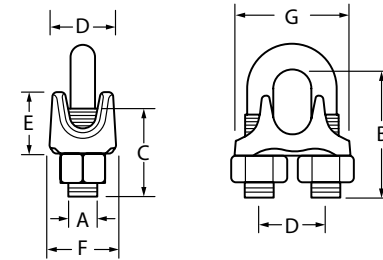

SIZE ROPE	MINIMUM CLIPS REQUIRED	AMT. WIRE ROPE TO TURN BACK	TORQUE IN POUNDS FOOT	APPROX. WEIGHT IN POUNDS	DROP FORGED WIRE ROPE CLIPS						
					A	B	C	D	E	F	G
1/8"*	2	3.1/4"	2.83	.05	.19	.75	.44	.44	.38	.81	.94
3/16"	2	3.3/4"	5.5	.10	.25	.94	.56	.56	.50	.94	1.19
1/4"	2	4.3/4"	12	.18	.31	1.06	.56	.75	.63	1.19	1.50
5/16"	2	5.1/4"	18.5	.31	.38	1.44	.75	.75	.75	1.31	1.69
3/8"	2	6.1/2"	25	.46	.44	1.50	.75	.88	.88	1.56	1.94
7/16"	3	7"	35	.73	.50	1.88	1.00	1.06	1.00	1.81	2.31
1/2"	3	11.1/2"	35	.73	.50	1.88	1.00	1.19	1.06	1.81	2.31
9/16"	3	12"	50	.96	.56	2.38	1.25	1.19	1.13	2.06	2.50
5/8"	3	12"	50	1.00	.56	2.38	1.25	1.31	1.25	2.06	2.50
3/4"	4	18"	100	1.50	.63	2.75	1.38	1.31	1.38	2.31	2.75
7/8"	4	19"	140	2.44	.75	3.19	1.44	1.50	1.69	2.63	3.31
1"	5	26"	140	2.7	.75	3.63	1.75	1.88	1.75	2.63	3.47
1.1/8"	6	34"	140	3.1	.75	4.00	2.00	2.00	1.88	2.81	3.56
1.1/4"	7	44"	275	4.6	.88	4.38	2.25	2.31	2.06	3.25	4.06
1.3/8"	7	44"	275	5.2	.88	4.63	2.31	2.38	2.25	3.44	4.25
1.1/2"	8	54"	275	5.9	.88	4.94	2.38	2.63	2.50	3.50	4.38
1.3/4"	8	61"	590	9.8	1.13	5.88	2.75	3.06	2.88	3.75	5.25
2"	8	71"	750	13.75	1.25	6.50	3.00	3.31	3.38	4.44	5.81
2.1/4"	8	73"	750	15.7	1.25	7.13	3.31	3.88	3.81	4.50	6.31

DROP FORGED WIRE ROPE CLIPS

Hot Dip Galvanized

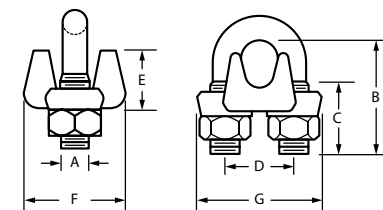

WIRE ROPE CLIPS



DROP FORGED FIST GRIP CLIPS		
SIZE ROPE	TORQUE IN POUNDS FOOT	APPROX WEIGHT IN POUNDS
3/16-1/4"	12	.23
5/16"	18.5	.28
3/8"	25	.40
7/16-1/2"	43	.62
9/16-5/8"	75	1.03
3/4"	100	1.75
7/8"	140	2.25
1"	190	3.00
1.1/8"	220	4.00

DROP FORGED FIST GRIP CLIPS

Hot Dip Galvanized

