

SWIVELS



 **M&G**
Industries

SWIVELS



SIZE (A)	WORKING LOAD LIMIT IN POUNDS	APPROXIMATE WEIGHT EACH IN POUNDS	EYE & EYE SWIVELS HOT GALVANIZED			
			B	C	E	F
1/4"	850	0.20	0.69	0.75	0.94	2.88
5/16"	1,250	0.38	0.75	1.00	1.13	3.63
3/8"	2,250	0.68	0.94	1.25	1.38	4.25
1/2"	3,600	1.4	1.38	1.50	1.94	5.63
5/8"	5,200	2.5	1.63	1.75	2.31	6.63
3/4"	7,200	3.9	1.81	2.00	2.56	7.25
7/8"	10,000	6.25	2.06	2.25	3.06	8.38
1"	12,500	9.00	2.31	2.50	3.50	9.00
1-1/8"	15,200	12.46	2.38	2.75	3.75	10.38
1-1/4"	18,000	16.37	2.69	3.13	4.00	11.13
1-1/2"	45,200	49.06	4.19	4.00	4.19	17.13

EYE & EYE SWIVELS

Hot Galvanized

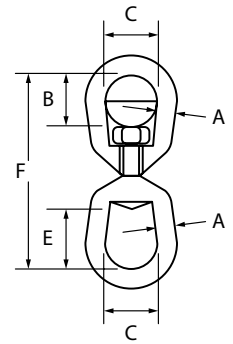

SIZE (A)	WORKING LOAD LIMIT IN POUNDS	APPROXIMATE WEIGHT EACH IN POUNDS	JAW & EYE SWIVELS HOT GALVANIZED					
			B	C	D	E	F	G
1/4"	850	0.22	0.69	0.75	0.38	0.88	2.69	0.25
5/16"	1,250	0.39	0.88	1.00	0.50	0.88	2.88	0.31
3/8"	2,250	0.71	0.94	1.25	0.63	1.00	3.50	0.38
1/2"	3,600	1.4	1.38	1.50	0.81	1.31	4.50	0.50
5/8"	5,200	2.3	1.63	1.75	1.00	1.50	5.31	0.63
3/4"	7,200	3.5	1.75	2.00	1.19	1.75	6.06	0.75
7/8"	10,000	5.75	2.06	2.25	1.19	2.06	7.00	.88
1"	12,500	10.25	2.21	2.50	1.75	2.81	8.56	1.13
1-1/8"	15,200	12.48	2.38	2.75	1.75	2.81	8.94	1.13
1-1/4"	18,200	15.75	2.69	3.13	2.06	2.81	9.44	1.38
1-1/2"	45,200	54.74	4.19	4.00	2.88	4.44	14.75	2.25

JAW & EYE SWIVELS

Hot Galvanized

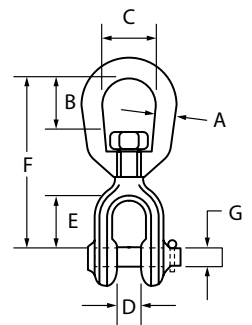

Read important warnings and information on the inside back cover of this catalog titled Cautions.